



HSE – Break-glass unit main

- HSE – main control panel
- HSE-N – secondary control panel
- HSE – main control panel in aluminium housing
- HSE – main control panel with buzzer
- BUS HSE – main control panel with BUS
- Frame – for flush mounting

To the product



Automatic detector

- Optical BUS smoke detector
- Optical smoke detector
- FAS Interface-Module
- Drive line end module
- Heat sensitive fire detector
- Heat sensitive detector clip 70°C

To the product



Power supply

- NT-DRA240-10 – Power supply 230 V AC / 24 V DC, 5 A
- NT-DRA240-10 – Power supply 230 V AC / 24 V DC, 10 A
- NT-DRA480-20 – Power supply 230 V AC / 24 V DC, 20 A
- External Power Supply Laser Sensor

To the product



Accessories for HSE (Break-glass unit)

- HSE-Empty Housing - Break-glass unit
- Key for plastic Break-glass unit
- Key for aluminium Break-glass unit
- Replacement glass panes for Break-glass unit
- Circuit board for Break-glass unit - ABS
- Circuit board for Break-glass unit

To the product

ORDER DATA

Part.-No.

HSE – Break-glass unit main control panel

Application: Break-glass unit with indicators and buttons for the manual control of the emergency open and close functions of a SHEV group, for connection in the detector line of a control unit.



TECHNICAL DATA (Rated values)

Operating voltage:	24 V DC
Ambient temperature range:	-5°C ... + 40°C
Housing:	Surface mounting, plastic (ABS)
Dimensions (WxHxD):	130 x 130 x 32 mm
Connections:	Screw terminal, 1,0 mm ² (rigid wire)
Protection rating:	IP30
Display:	Emergency OPEN, power, fault
Control elements:	Buttons for emergency OPEN / CLOSE

ABS

Feature/Equipment

- Lockable, glazed door (including key)
- **Connection to the detector line input**
- HSE orange: **VdS certification no. G 501006**

VERSIONS

HSE red	(similar to RAL 3000)	528691		
HSE yellow	(similar to RAL 1018)	528692		
HSE grey	(similar to RAL 7035)	528693		
HSE blue	(similar to RAL 5015)	528694		
HSE orange	(similar to RAL 2011)	528695		

HSE-N – Break-glass unit secondary control panel

Application: Break-glass unit with indicator and button for the manual control of the emergency open function of a SHEV group, for connection in the detector line of a control unit.



TECHNICAL DATA (Rated values)

Operating voltage:	24 V DC
Ambient temperature range:	-5°C ... + 40°C
Housing:	Surface mounting, plastic (ABS)
Dimensions (WxHxD):	130 x 130 x 32 mm
Connections:	Screw terminal, 1,0 mm ² (rigid wire)
Protection rating:	IP30
Display:	Emergency OPEN
Control elements:	Button for emergency OPEN

ABS

Feature/Equipment

- Lockable, glazed door (including key)
- **Connection to the detector line input**
- HSE orange: **VdS certification no. G 501006**

VERSIONS

HSE-N red	(similar to RAL 3000)	525001		
HSE-N yellow	(similar to RAL 1018)	525002		
HSE-N grey	(similar to RAL 7035)	525003		
HSE-N blue	(similar to RAL 5015)	525004		
HSE-N orange	(similar to RAL 2011)	525005		

ORDER DATA

Part.-No.

HSE – Break-glass unit main control panel (aluminium housing)

Application: Break-glass unit with indicators and buttons for the manual control of the emergency open and close functions of a SHEV group, for connection in the detector line of a control unit.

**TECHNICAL DATA (Rated values)**

Operating voltage:	24 V DC
Ambient temperature range:	-5°C ... + 40°C
Housing:	Surface mounting, aluminium
Dimensions (WxHxD):	125 x 125 x 33 mm
Connections:	Screw terminal, 1,0 mm ² (rigid wire)
Protection rating:	IP41
Display:	Emergency OPEN, power, fault
Control elements:	Buttons for emergency OPEN / CLOSE

ALU**Feature/Equipment**

- Lockable, glazed door (including key)
- **Connection to the detector line input**

VERSIONS

HSE-Alu red	(similar to RAL 3001)	527550		
HSE-Alu yellow	(similar to RAL 1012)	527551		
HSE-Alu grey	(similar to RAL 7035)	527552		
HSE-Alu blue	(similar to RAL 5012)	527553		
HSE-Alu orange	(similar to RAL 2011)	527554		
Protective housing IP54 for break-glass unit HSE-Alu gray – add-on kit		527559		

HSE – Break-glass unit main control panel - buzzer

Application: Break-glass unit with built-in buzzer and indicators and buttons for the manual control of the emergency open and close functions of a SHEV group, for connection in the detector line of a control unit.

**TECHNICAL DATA (Rated values)**

Operating voltage:	24 V DC
Ambient temperature range:	-5°C ... + 40°C
Housing:	Surface mounting, plastic (ABS)
Dimensions (WxHxD):	130 x 130 x 32 mm
Connections:	Screw terminal, 1,0 mm ² (rigid wire)
Protection rating:	IP30
Display:	Emergency OPEN, power, fault
Control elements:	Button for emergency OPEN / CLOSE

ABS**SUMMER****Feature/Equipment**

- Built-in buzzer
- Lockable, glazed door (including key)
- **Connection to the detector line input**
- Settings via DIP switch: Warning sound in case of fault and / or SHEV

VERSIONS

HSE red	(similar to RAL 3000)	528711		
HSE yellow	(similar to RAL 1018)	528712		
HSE grey	(similar to RAL 7035)	528713		
HSE blue	(similar to RAL 5015)	528714		
HSE orange	(similar to RAL 2011)	528715		

ORDER DATA

Part.-No.

HSE – Break-glass unit main control panel

Application: Break-glass unit with indicators and buttons for the manual control of the emergency open and close functions of a SHEV group, for connection in the BUS line of a control unit.



TECHNICAL DATA (Rated values)

Operating voltage:	24 V DC
Ambient temperature range:	-5°C ... + 40°C
Housing:	Surface mounting, plastic (ABS)
Dimensions (WxHxD):	130 x 130 x 32 mm
Connections:	BUS terminal, 2 x 0,8 mm ²
Protection rating:	IP30
Display:	Emergency OPEN, power, fault
Control elements:	Buttons for emergency OPEN / CLOSE
Connection possibility:	Ventilation push button - input Screw terminal, 1,0 mm ² (rigid wire)

ABS

BUS

Feature/Equipment

- Lockable, glazed door (including key)
- **Connection to the detector line input**

VERSIONS

HSE red	(similar to RAL 3000)	528491		
HSE yellow	(similar to RAL 1018)	528492		
HSE grey	(similar to RAL 7035)	528493		
HSE blue	(similar to RAL 5015)	528494		
HSE orange	(similar to RAL 2011)	528495		

HSE – Frame for flush mounting

528015

Application: Flush mounting of break-glass units.

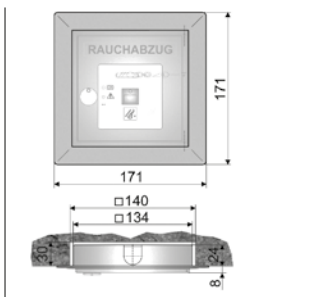

TECHNICAL DATA

Housing:	Surface mounting, steel sheet
Dimensions (WxHxD):	171 x 171 x 26 mm
Surface:	powder-coated in light grey w/o structure
Installation Dimensions:	140 x 140 x 30 mm

ABS

Feature/Equipment

- Suitable for break glass units with plastic housing 130 x 130 x 32 mm

ORDER DATA

	Part.-No.
Optical BUS-smoke detector	531530
Application: BUS-smoke detector for the automatic early detection of fire for controlling of the EMERGENCY OPEN function via the BUS detector line of the EMB 8000+ , with smoke generation in the monitored area.	



TECHNICAL DATA (Rated values)

Measuring element:	photo electric / scattered light principle
Operating voltage:	12 V DC via BUS
Standby current:	< 110 µA
Housing:	Surface mounting, plastic (ABS), signal white (similar to RAL 9003)
Dimensions (WxHxD):	Ø120 x 60 mm
Connections:	Screw terminals 1,0 mm ² (rigid wire)
Protection rating:	IP30
Ambient temperature range:	-10°C ... +55°C
Display:	Alarm LED

BUS

Feature/Equipment

- Fire algorithms for avoiding false alarms, automatic alarm threshold tracking
- According to EN 54-7, Connection to the **BUS detector line input**
- **VdS certification no. G 209219**

Optical smoke detector	531520
Application: Smoke detector for the automatic early detection of fire for controlling of the EMERGENCY OPEN function via a detector line of SHEV control units, with smoke generation in the monitored area.	



TECHNICAL DATA (Rated values)

Measuring element:	photo electric / scattered light principle
Operating voltage:	8,5 – 33 V DC
Standby current:	< 100 µA
Housing:	Surface mounting, plastic (ABS), pearl white
Dimensions (WxHxD):	Ø100 x 50 mm
Connections:	Screw terminals 1,0 mm ² (rigid wire)
Protection rating:	IP23D
Display:	Alarm LED

Feature/Equipment

- Fire algorithms for avoiding false alarms, automatic alarm threshold tracking
- According to EN 54-7, connection to the **detector line input**

ACCESSORIES

Ball protection (chromed steel grid) e.g. use in sporthalls	513546
---	---------------

FAS Interface-Module	670053
Application: Module for the automatic control of the emergency open function via volt free contact of a fire alarm system.	

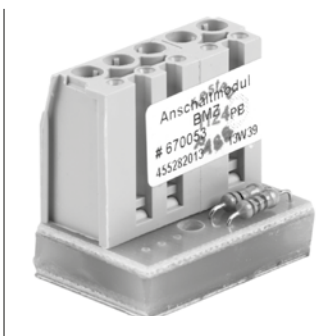

TECHNICAL DATA (Rated values)

Operating voltage:	24 V DC
Standby consumption:	<10 mA
Ambient temperature range:	0 ... +40 °C
Housing:	w/o, equipped circuit board
Dimensions (WxHxD):	27 x 19 x 13 mm
Connections:	Screw terminal 1,5 mm ² (rigid wire)
FAS contact:	Normal open switch at alarm status

Feature/Equipment:

- For connection to **detector line input** of SHEV control units, with line monitoring between control unit and module

ORDER DATA

		Part.-No.		
Drive line end module		670052		
Application: For installation in the last or only junction box for the line monitoring of drive line.				



TECHNICAL DATA (Rated values)

Operating voltage:	24 V DC (+/-5%)
Standby consumption:	<10 mA
Ambient temperature range:	0 ... +70 °C
Housing:	w/o, equipped circuit board
Dimensions (WxHxD):	27 x 19 x 13 mm
Connections:	3 single cores

Feature/Equipment

- For connection into **drive line** of SHEV control units

Heat sensitive fire detector				
Application: Heat detector for the automatic control of the emergency open function of a SHEV group of a SHEV control unit.				



TECHNICAL DATA (Rated values)

Measuring element:	Bimetal switch
Operating voltage:	24 V DC
Contact load:	48 V DC / 0,5 A
Standby current:	< 10 mA
Housing:	Surface mounting, plastic (ABS), white
Dimensions (WxHxD):	Ø56 x 77 mm
Connections:	Screw terminals 1,0 mm² (rigid wire)
Protection rating:	IP20

Feature/Equipment

- With base for surface mounting

VERSIONS

Connection in detector line	NO switch 70°C	533205		
Connection in drive line	NC switch 70°C	533200		

Heat sensitive detector clip 70°C		533201		
Application: Heat detector for controlling of the emergency open function of a SHEV group, for connection in the drive line.				

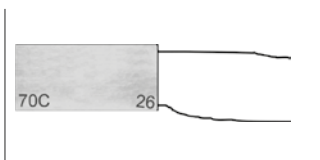

Measuring element:	Bimetal switch with ceramic housing
Operating voltage:	24 V DC
Contact type:	NC switch at 70°C
Contact load:	48 V DC / 0,5 A
Standby current:	< 10 mA

Feature/Equipment

- No housing, connection in the **monitoring line of the drive output** of a SHEV control unit

ORDER DATA

Part.-No.

NT-DRAN120-5 – Power supply 230 V AC / 24 V DC, 5 A

680005

Application: Switching power supply for fixing on 35-mm mounting rail or external power supply of the ventilation modules LZA and LZH.

**TECHNICAL DATA**

Operating voltage:	230 V AC (195 – 253 V AC, 50/60 Hz)
Power consumption max. :	322 W
Output voltage:	24 V DC (20 – 28 V DC / 0,5 Vpp)
Output current:	5 A
Ambient temperature range:	-5°C ... + 40°C
Housing:	for fixing on 35-mm mounting rail
Dimensions (WxHxD):	65 x 95 x 123 mm

Feature/Equipment

- For installation in a control cabinet or comparable housing.

NT-DRA240-10 – Power supply 230 V AC / 24 V DC, 10 A

680010

Application: Switch mode power supply for power supply and control of drives 24 V DC for daily ventilation, with one ventilation line. Control in the OPEN / CLOSE direction via the 230 V AC mains voltage.

**TECHNICAL DATA**

Operating voltage:	230 V AC (195 - 253 V AC, 50/60 Hz)
Output voltage:	24 V DC (20 – 28 V DC / 0,5 Vpp)
Output current:	10 A
Ambient temperature range:	-5°C ... + 40°C
Housing:	for fixing on 35-mm mounting rail
Dimensions (WxHxD):	125 x 84 x 124 mm

Feature/Equipment

- For installation in a control cabinet or comparable housing.

NT-DRA480-20 – Power supply 230 V AC / 24 V DC, 20 A

680024

Application: Switch mode power supply for power supply and control of drives 24 V DC for daily ventilation, with one ventilation line. Control in the OPEN / CLOSE direction via the 230 V AC mains voltage.

**TECHNICAL DATA**

Operating voltage:	230 V AC (195 - 253 V AC, 50/60 Hz)
Output voltage:	24 V DC (20 – 28 V DC / 0,5 Vpp)
Output current:	20 A
Ambient temperature range:	-5°C ... + 40°C
Housing:	for fixing on 35-mm mounting rail
Dimensions (WxHxD):	125 x 176 x 124 mm

Feature/Equipment

- For installation in a control cabinet or comparable housing.

ORDER DATA

	Part.-No.
External Power Supply Laser Sensor	680027
Application: External Power Supply NT-S-2 KS2/KSA - 230 V AC / 24 V DC factory installed in KS2 chain drive housing. For power supply and control of SKL3 flatscan and flat scan sensor.	

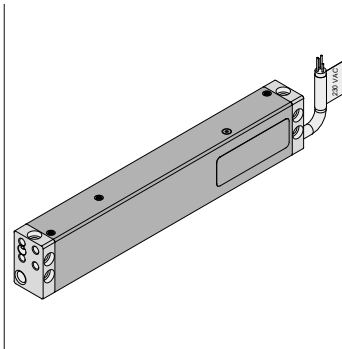

TECHNICAL DATA (Rated values)

Operating voltage:	230 V AC (195 – 253 V AC, 50/60 Hz)
Record measurement:	30 W
Output voltage:	24 V DC (20 – 28 V DC / 2 Vpp)
Output current:	2,0 A
Output:	1x drive line - 24 V DC / 2,0 A 1x continuous current - 24 V DC / 0,2 A
Connections:	24 V DC drive, up to max. 2,0 A 24 V DC continuous current, up to max. 0,2 A
Connection cable:	non-halogen, grey 6 x 0,75 mm ² , length 3 meters maximum extendable to 25 meters in length
Housing:	Aluminium natural anodized
Dimensions (WxHxD):	41 x 26 x 230 mm
Connection terminals:	Screw terminals 1,0 mm ² (rigid wire)
Protection rating:	IP 32

Feature/Equipment

- Factory installed in the housing of a KS2 chain drive.

For this product series, a Type III Environmental Product Declaration (EPD) was issued according to ISO 14025 and EN 15804.

The LCA results of the different product types are listed at the end of this product catalogue.

The EPD documents can be viewed or downloaded from our homepage www.aumueller-gmbh.de.

ORDER DATA

Part.-No.

HSE-Empty Housing - Break-glass unit

Application: HSE-Empty Housing with lockable, glazed door - including key.**TECHNICAL DATA (Rated values)**Housing:
Dimensions (WxHxD):**Surface mounting, plastic (ABS)**
130 x 130 x 32 mm**ABS**

VARIANTEN

HSE-Empty Housing red	(similar to RAL 3000)	528001			
HSE-Empty Housing yellow	(similar to RAL 1018)	528002			
HSE-Empty Housing grey	(similar to RAL 7035)	528003			
HSE-Empty Housing blue	(similar to RAL 5015)	528004			
HSE-Empty Housing orange	(similar to RAL 2011)	528009			

Key for plastic Break-glass unit (HSE plastic button)

527007

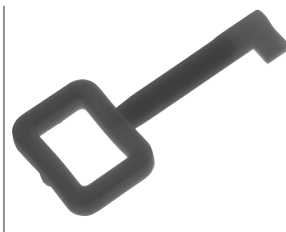
Application: The plastic Break-glass units (HSE plastic button) have a lockable door.
The key is used to open or close this door.**TECHNICAL DATA**Function: for plastic Break-glass unit (HSE plastic button)
Material: Polyamid PA 6.6
Colour: white

Key: 1 piece

Feature/Equipment

- Suitable for all **AUMÜLLER** plastic Break-glass unit (HSE plastic buttons)

Key for aluminium Break-glass unit (HSE aluminium button)

527008

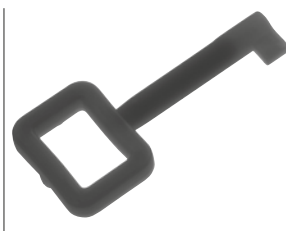
Application: The aluminium Break-glass units (HSE aluminium button) have a lockable door.
The key is used to open or close this door.**TECHNICAL DATA**Function: for aluminium Break-glass unit (HSE aluminium button)
Material: Metal
Type: Schl-HM/10

Keys: 10 pieces

Feature/Equipment

- Suitable for all **AUMÜLLER** aluminium Break-glass unit (HSE aluminium buttons)

ORDER DATA

	Part.-No.			
Replacement glass panes for Break-glass unit (HSE button)	527002			
Application: Panes of glass for replacement on site.				

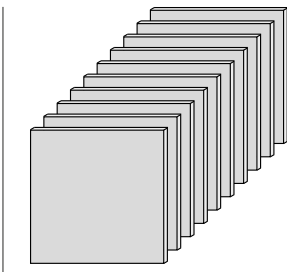

TECHNICAL DATA

Dimensions (W x H x D):
Glass panes:

80 x 80 x 0,7
10 pieces

Feature/Equipment

- Suitable for all **AUMÜLLER** Break-glass unit (HSE buttons)

Circuit board for Break-glass unit ABS (HSE button ABS)				
Application: Circuit board for Break-glass unit (HSE button) - with logo „Ferralux“. Can be exchanged on site - without subsequent processing.				



TECHNICAL DATA

Type:

For housing type:

Ferralux DIN99-1 A-Z /A-B-S, is equipped
Installation in an ABS housing
Plastic

ABS

VERSIONS

with certification VdS	528785			
without certification VdS	528784			

Circuit board for Break-glass unit (HSE button)				
Application: Circuit board for Break-glass unit (HSE button) - with logo „Ferralux“. Can be exchanged on site - without subsequent processing.				

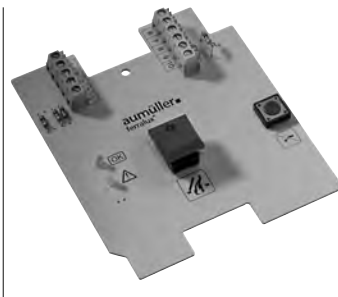

TECHNICAL DATA

Type:

For housing type:

Ferralux DIN AL4 orange, is equipped
Installation in an aluminum housing
Aluminium

ALU

VERSIONS

VdS similar version	528782			
without certification VdS	528789			